



通过人脸验证注册Singpass账户

安装Singpass应用程序



设置SGWorkPass应用程序

通过人脸验证注册 Singpass 账户

人脸验证注册 **SINGPASS**

前往 www.singpass.gov.sg。点击“注册 Singpass”。

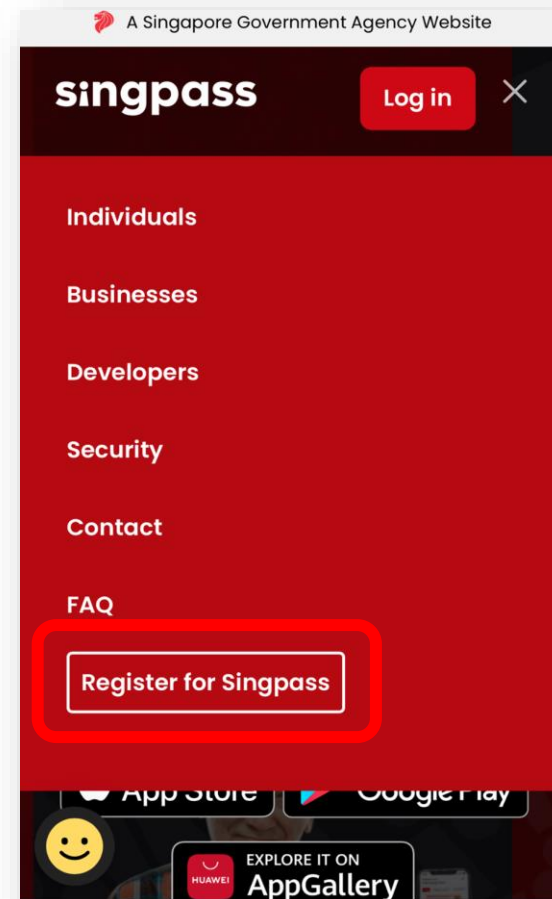
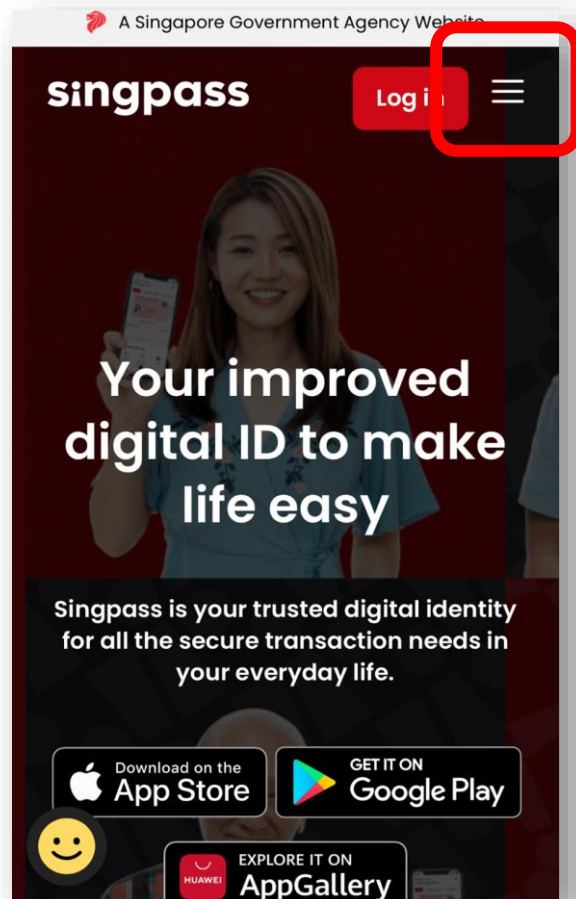

人脸验证注册 SINGPASS

2. 输入所需的详细信息，然后勾选“我不是机器人”和“我已阅读并同意使用条款”。接下来，点击“提交”。

您可在您的工作准证卡查看申请日期。

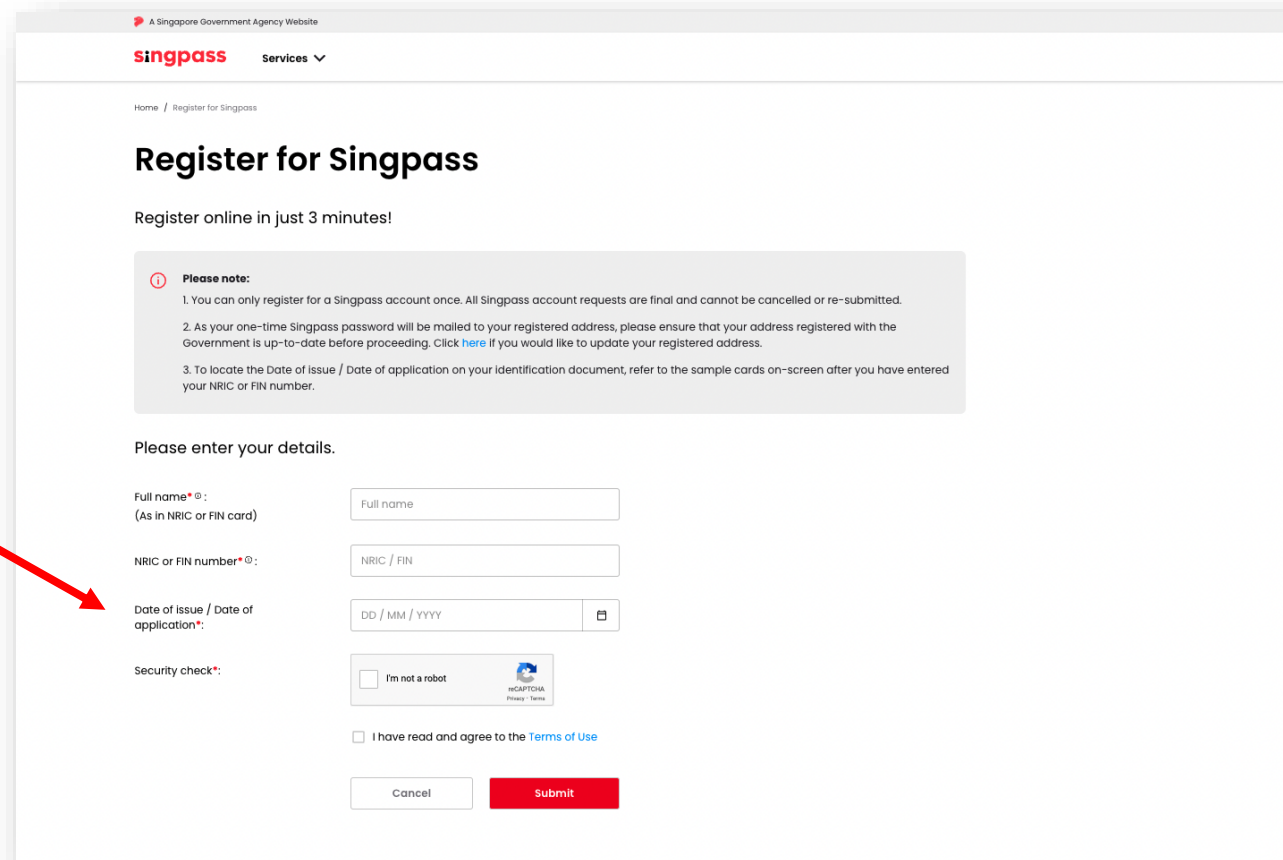

The screenshot shows the Singpass registration page. At the top, it says "A Singapore Government Agency Website" and "singpass Services". The main heading is "Register for Singpass" with a sub-heading "Register online in just 3 minutes!". Below this is a "Please note" section with three points: 1. You can only register for a Singpass account once. 2. As your one-time Singpass password will be mailed to your registered address, please ensure that your address registered with the Government is up-to-date before proceeding. 3. To locate the Date of issue / Date of application on your identification document, refer to the sample cards on-screen after you have entered your NRIC or FIN number. The form fields are: Full name* (As in NRIC or FIN card), NRIC or FIN number* (NRIC / FIN), Date of issue / Date of application* (DD / MM / YYYY), and Security check* (I'm not a robot, I have read and agree to the Terms of Use). There are "Cancel" and "Submit" buttons at the bottom.

singpass

人脸验证注册 SINGPASS

3. 阅读页面上的指示，点击“继续”进行人脸验证。

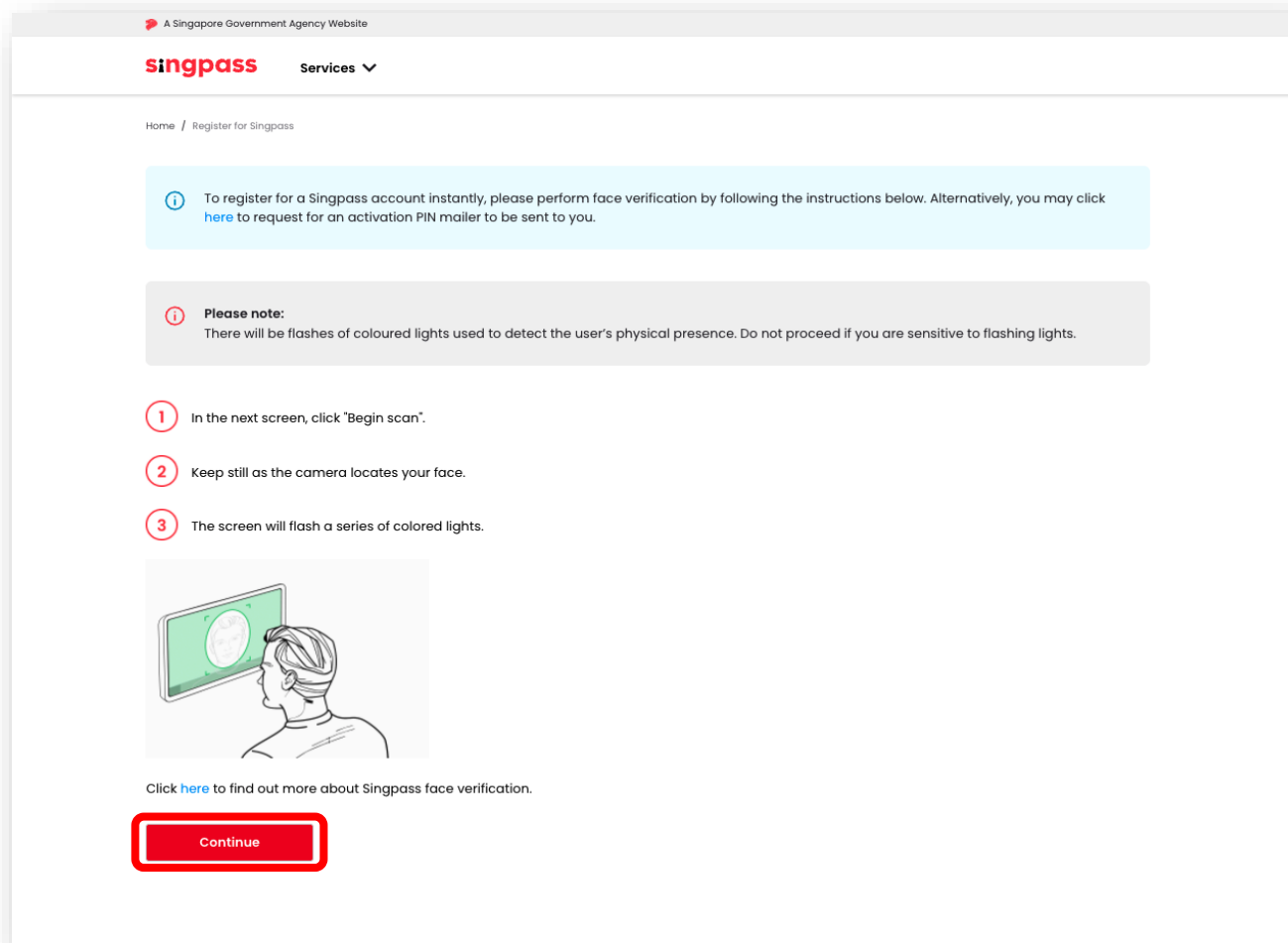

A Singapore Government Agency Website

singpass Services ▾

Home / Register for Singpass

i To register for a Singpass account instantly, please perform face verification by following the instructions below. Alternatively, you may click [here](#) to request for an activation PIN mailer to be sent to you.

i **Please note:**
There will be flashes of coloured lights used to detect the user's physical presence. Do not proceed if you are sensitive to flashing lights.

- 1** In the next screen, click "Begin scan".
- 2** Keep still as the camera locates your face.
- 3** The screen will flash a series of colored lights.



Click [here](#) to find out more about Singpass face verification.

Continue

人脸验证注册 **SINGPASS**

4. 阅读页面上的指示。欲允许使用设备的摄像头进行人脸验证，请在提示出现时点击“允许”，然后点击“开始扫描”。

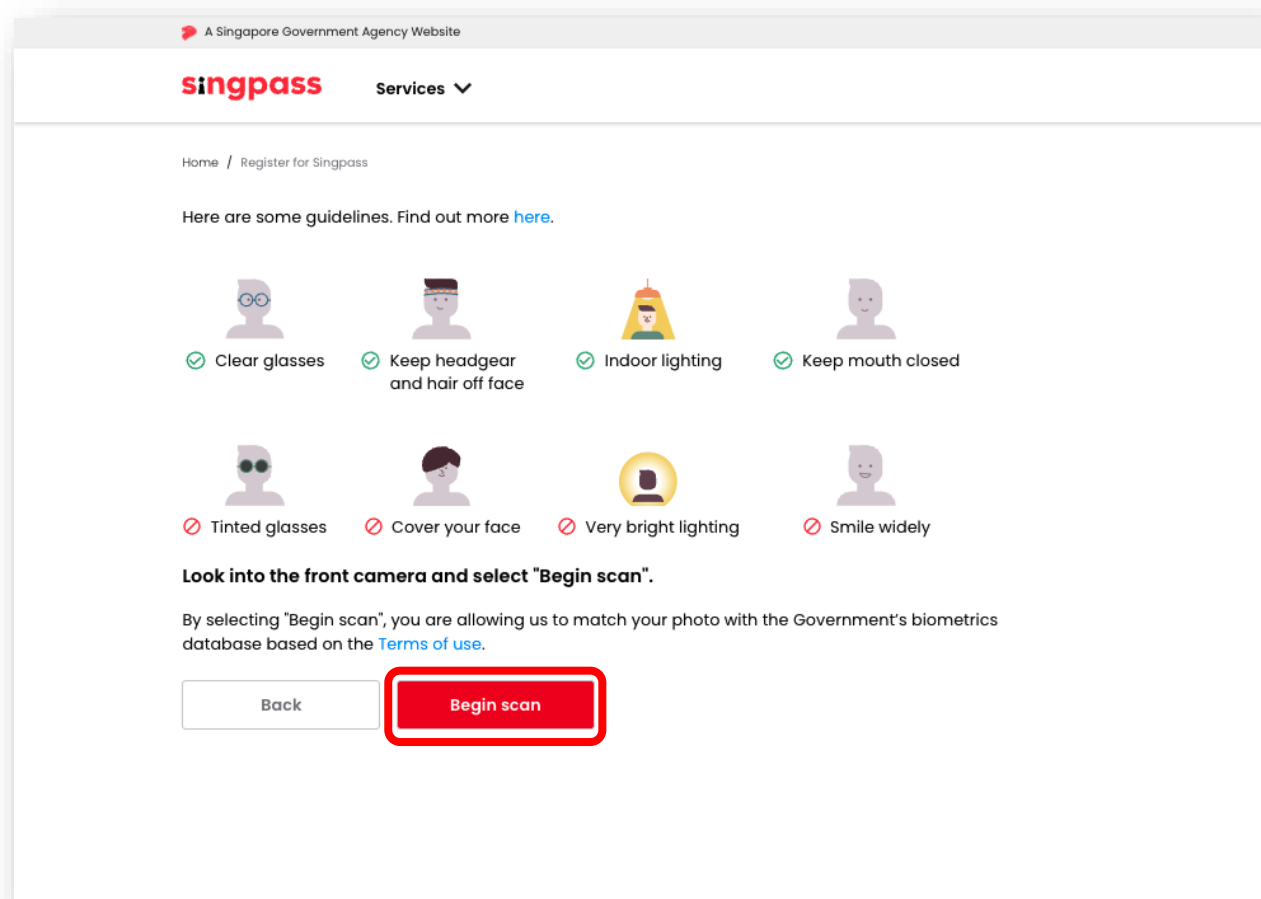

人脸验证注册 **SINGPASS**

5. 验证成功后，您将看到以下通知。

Successfully verified your identity



人脸验证注册 SINGPASS

6. 确认您的详细信息正确无误。在“新密码”和“确认新密码”字段中输入新密码，然后点击“下一步”。

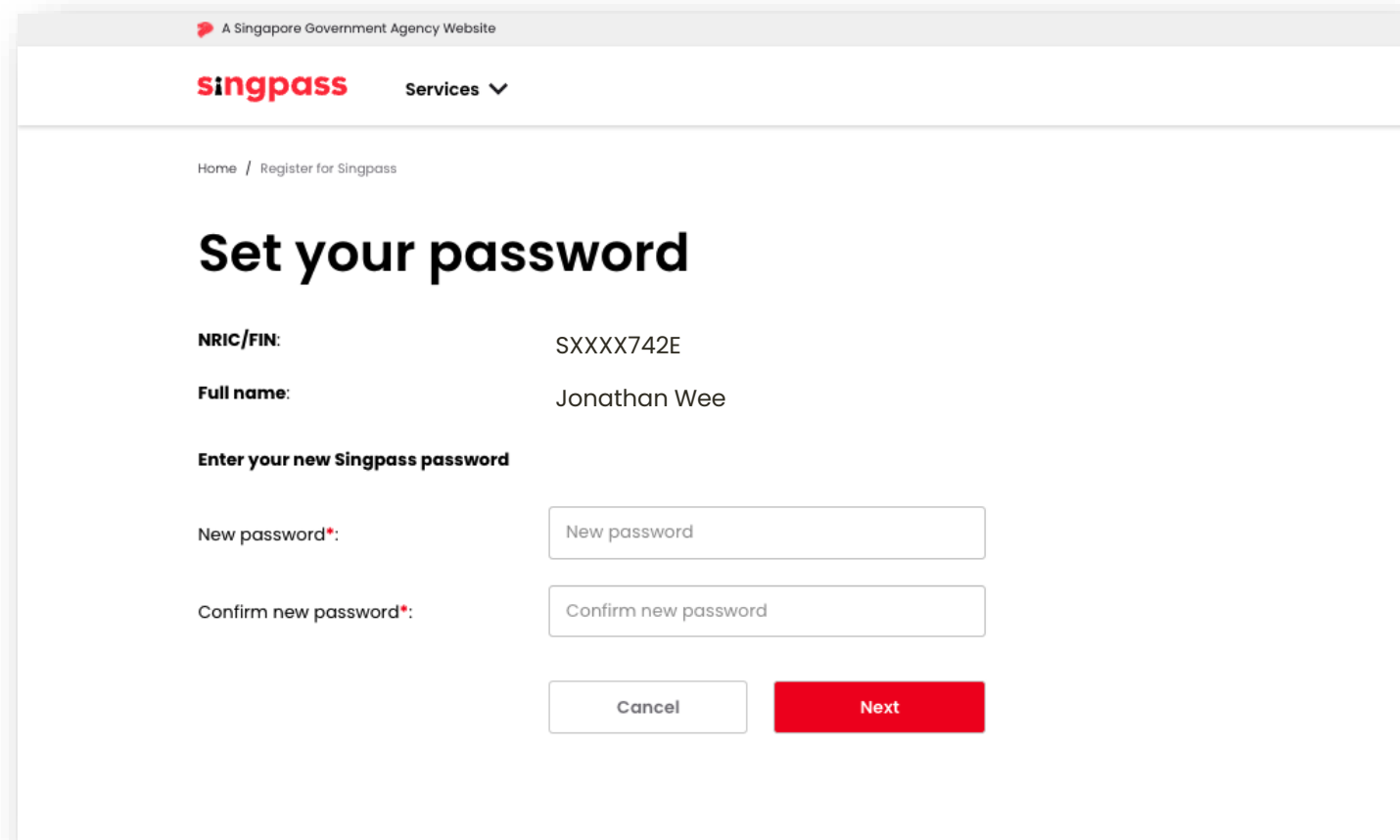

The screenshot shows the Singpass registration interface. At the top, it says 'A Singapore Government Agency Website' and 'singpass Services'. The breadcrumb trail is 'Home / Register for Singpass'. The main heading is 'Set your password'. Below this, the user's details are displayed: 'NRIC/FIN: SXXXX742E' and 'Full name: Jonathan Wee'. The section 'Enter your new Singpass password' contains two input fields: 'New password*' and 'Confirm new password*'. At the bottom, there are two buttons: 'Cancel' and 'Next'.

A Singapore Government Agency Website

singpass Services ▾

Home / Register for Singpass

Set your password

NRIC/FIN: SXXXX742E

Full name: Jonathan Wee

Enter your new Singpass password

New password*:

Confirm new password*:

人脸验证注册 **SINGPASS**

7.您已成功注册Singpass账户。点击“继续设置账户”。

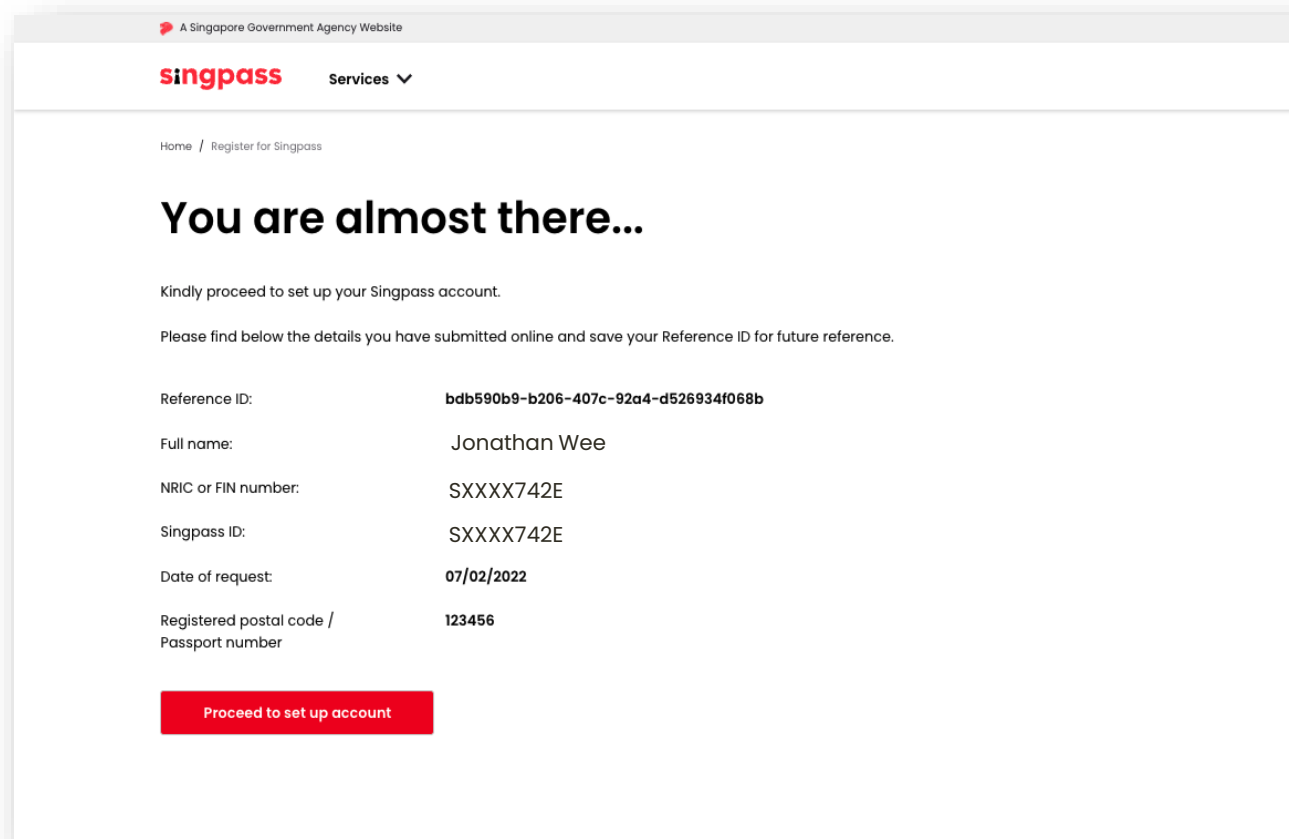

人脸验证注册 SINGPASS

8. 输入您在新加坡注册的手机号码。

A Singapore Government Agency Website

singpass Services ▾

Home / Register for Singpass

Contact update

Your mobile number and email address can only be registered to **ONE** Singpass account.

By providing your mobile number, it will be activated for SMS 2FA instantly upon verification.

Mobile number^{⓪*}:

Email address[▲]:

Preferred mode of contact^{*}: SMS Email

Go green with paperless notification (SMS/Email)^{*}: Yes No

*Mandatory for users with a Singapore-registered address
▲Mandatory for users with an overseas-registered address

点击“下一步”。

人脸验证注册 **SINGPASS**

9. 一个一次性密码将被发送到您的手机。输入此一次性密码，然后点击“下一步”。

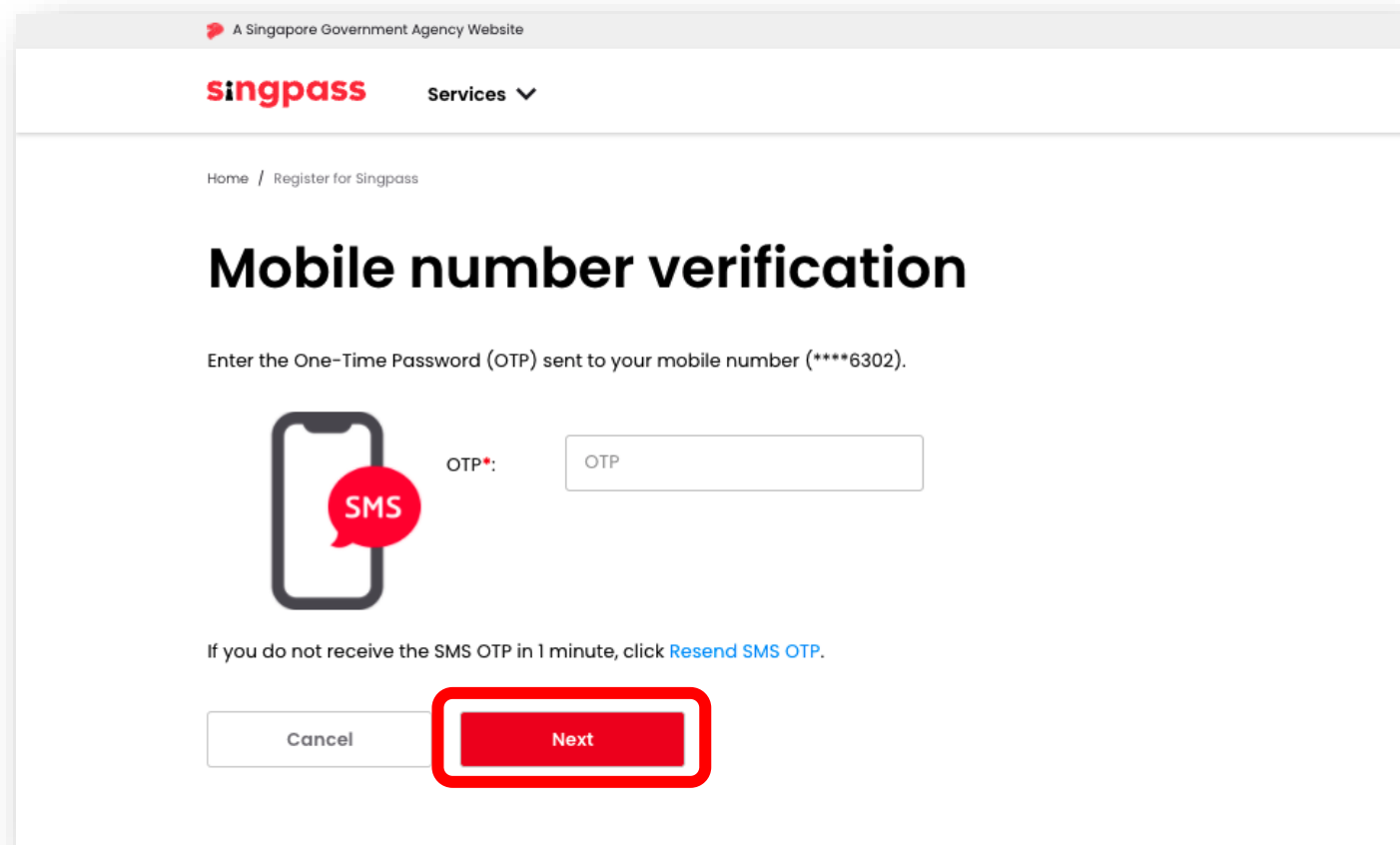

A Singapore Government Agency Website

singpass Services ▾

Home / Register for Singpass

Mobile number verification

Enter the One-Time Password (OTP) sent to your mobile number (****6302).

 OTP*:

If you do not receive the SMS OTP in 1 minute, click [Resend SMS OTP](#).

人脸验证注册 SINGPASS

10.您已完成Singpass账户设置并更新了账户的详细信息。

接下来，请从官方应用商店下载 Singpass应用程序。

按照指示安装应用程序。

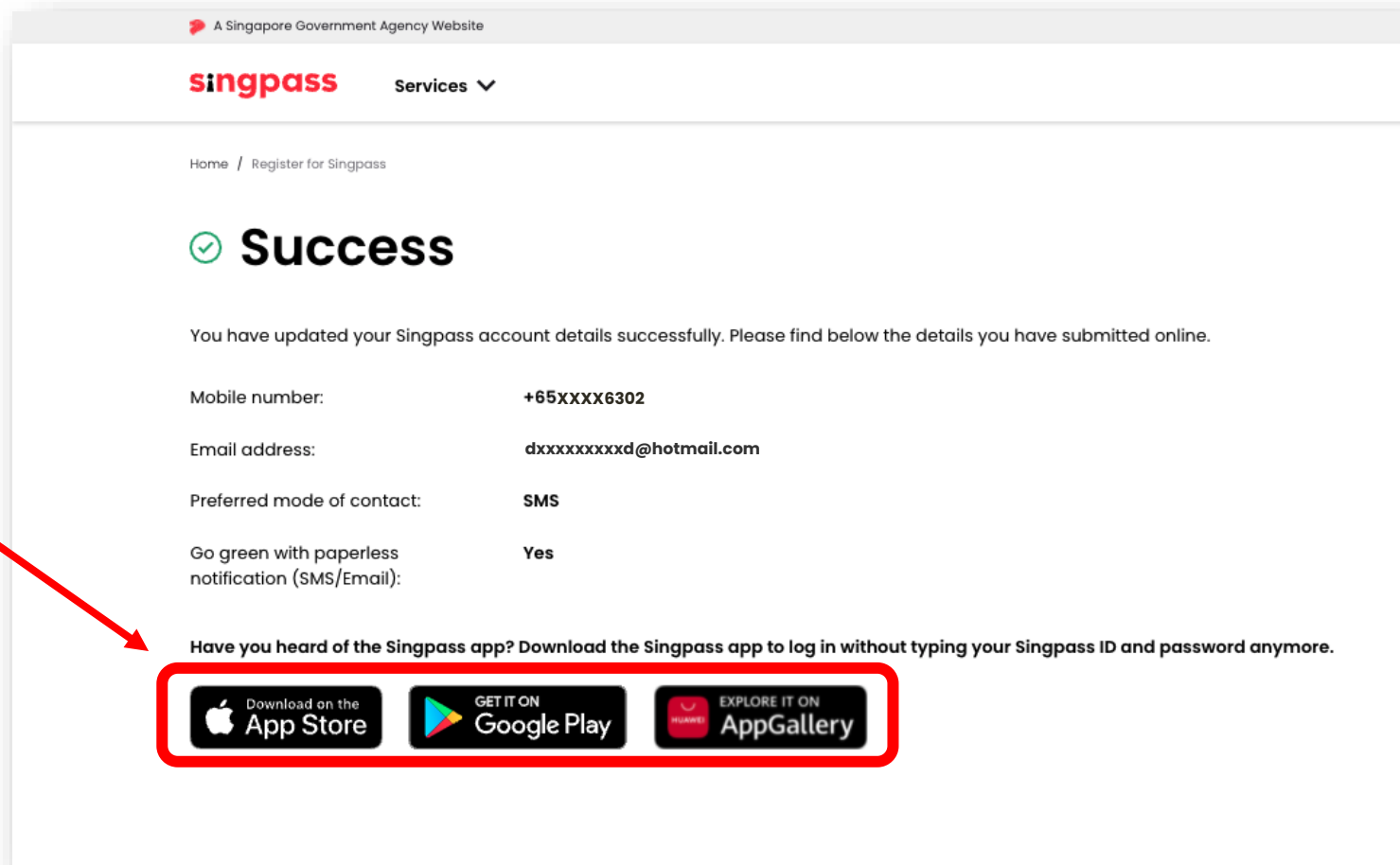



安装 **Singpass**
应用程序

身份验证

1 输入您的外国人身份证号码和Singpass密码。接下来，点击“登录”。

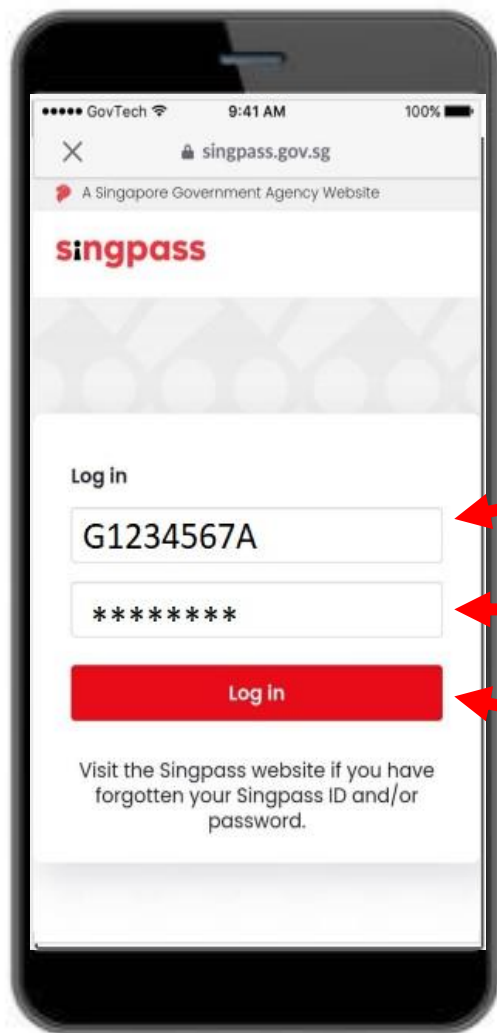

在此输入外国人身份证号码

在此输入密码

Log in



身份验证

2 点击“我不是机器人”。

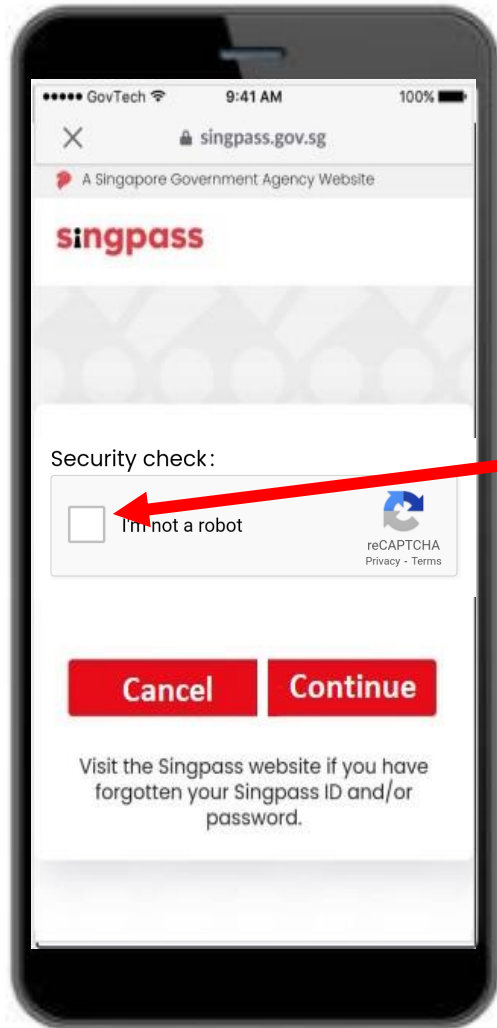

Security check:



I'm not a robot



reCAPTCHA
Privacy - Terms



身份验证

3 按照蓝色框中的指示进行操作。

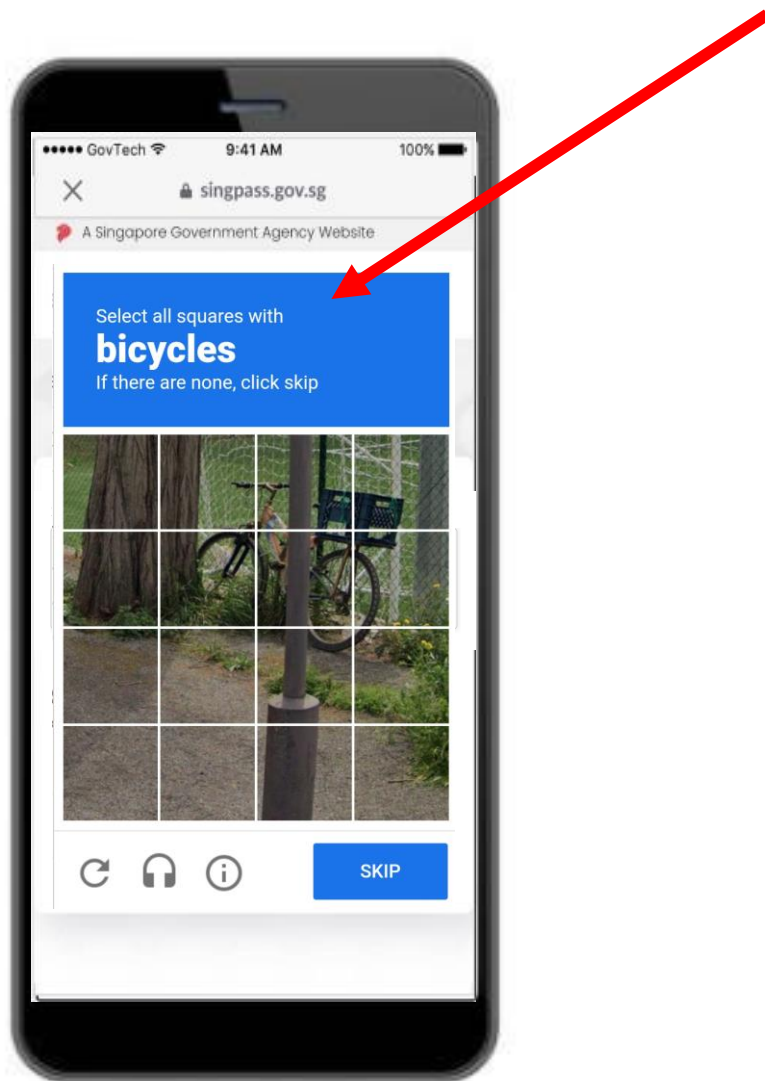

身份验证

4 点击“继续”。

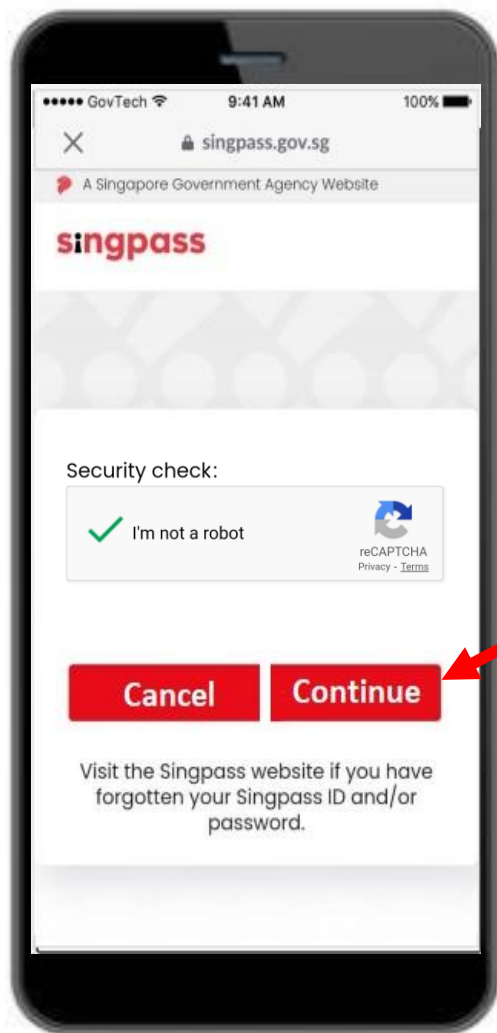

身份验证

5 输入通过短信发送到您手机的一次性密码。

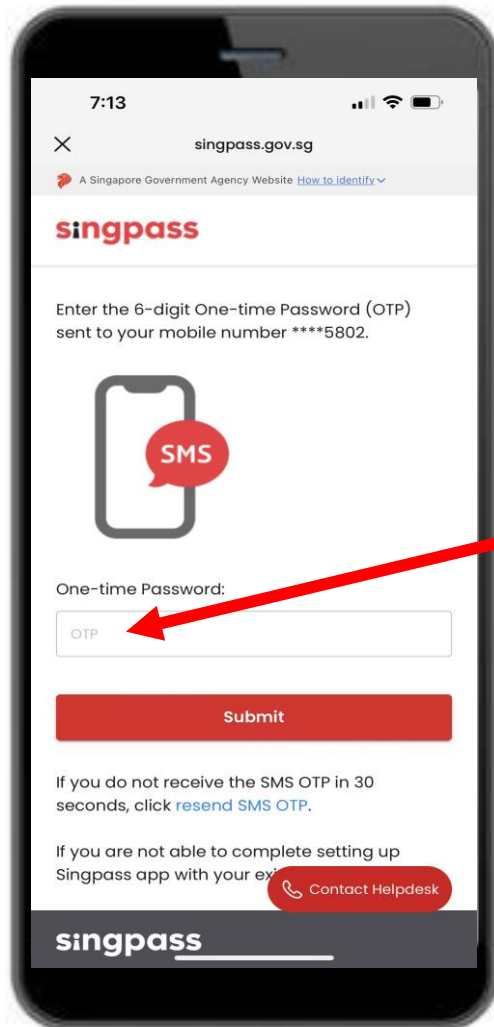

Your SMS OTP is **000000**. It will expire after 2 minutes. For security reasons, please do not share the OTP with anyone. Sent: 20/01/2022 11:32 AM [G0000000A].



身份验证

6 点击“提交”。

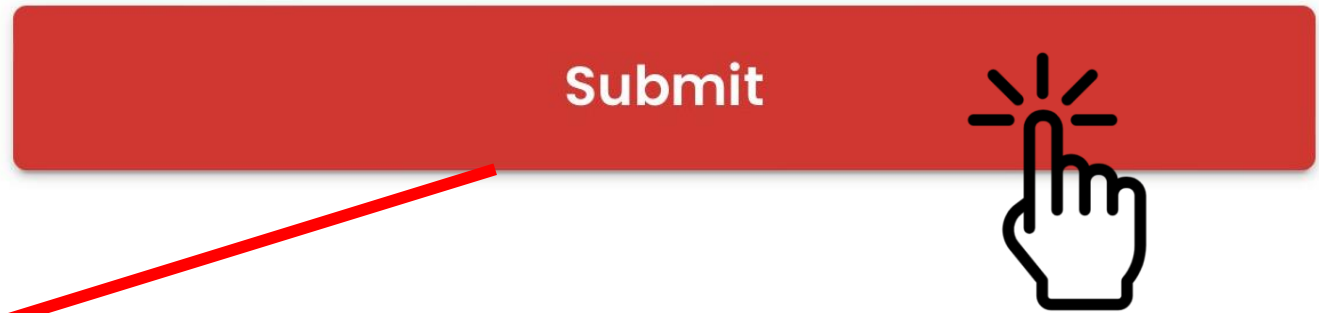
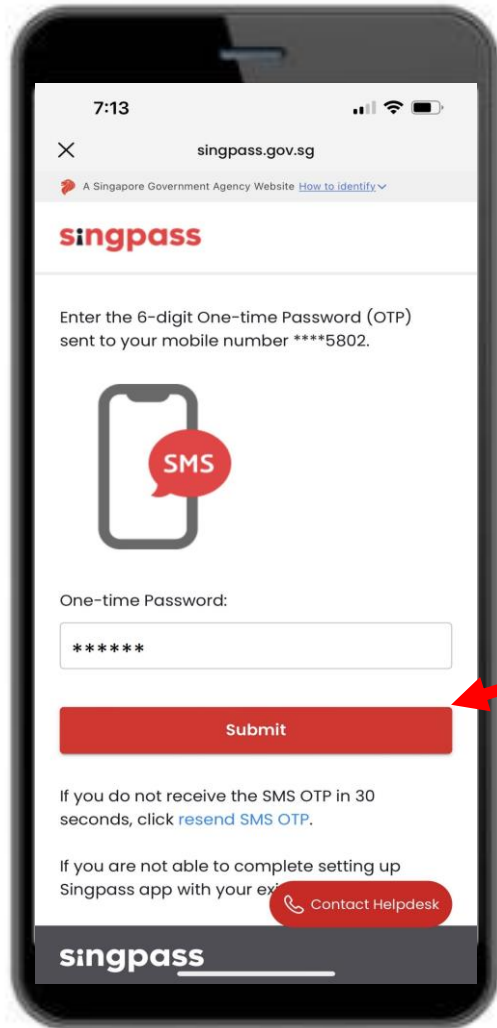

身份验证

7 阅读指示。点击“继续”进行Singpass人脸验证。

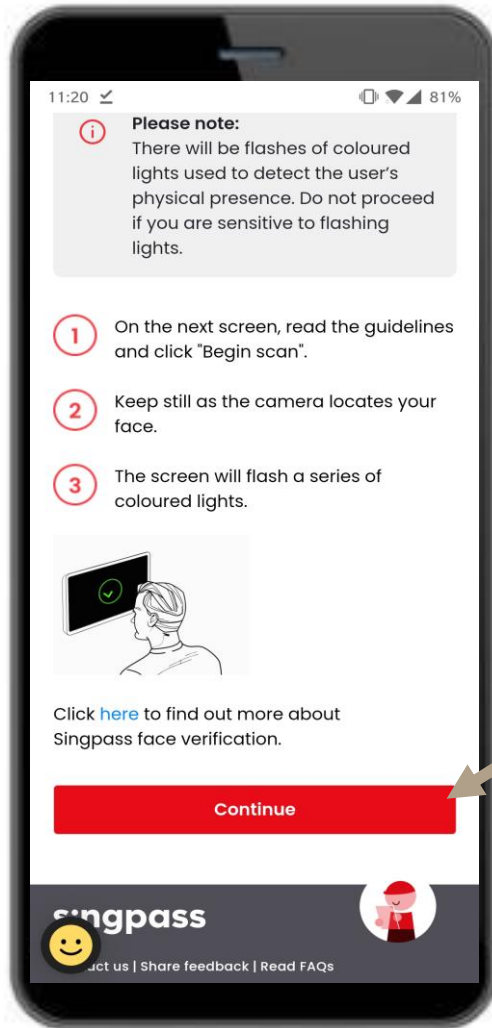

身份验证

8 点击“开始扫描”以进行面部扫描。

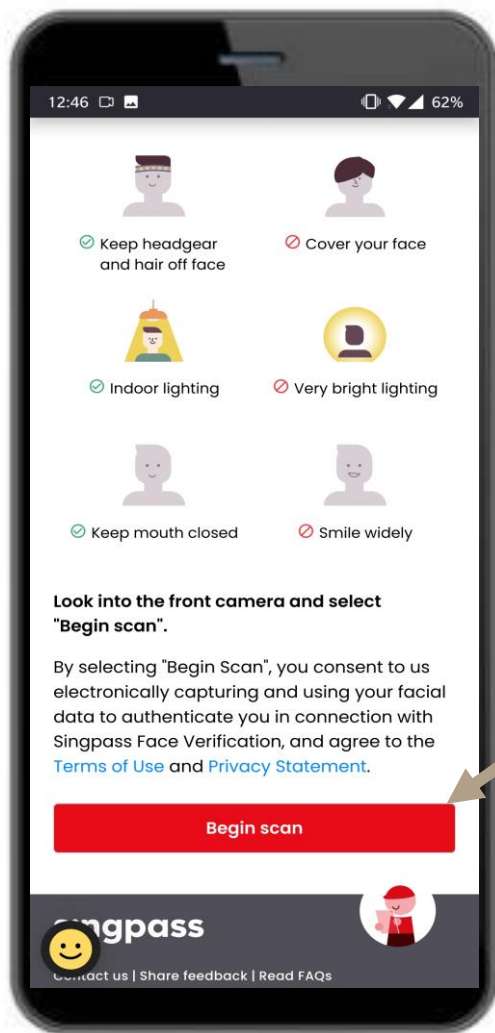

身份验证

9 点击“允许”以启用相机权限进行面部扫描。

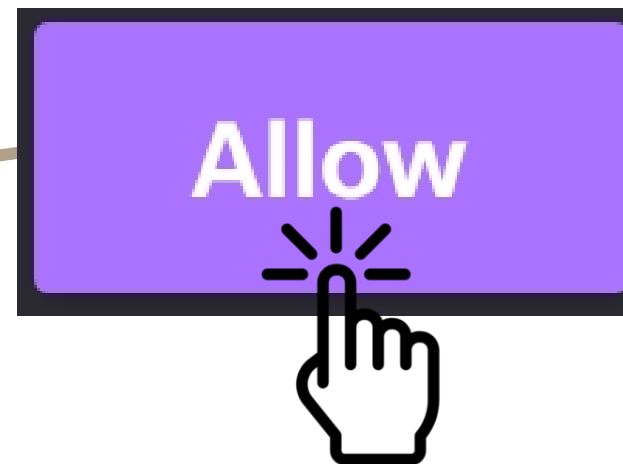
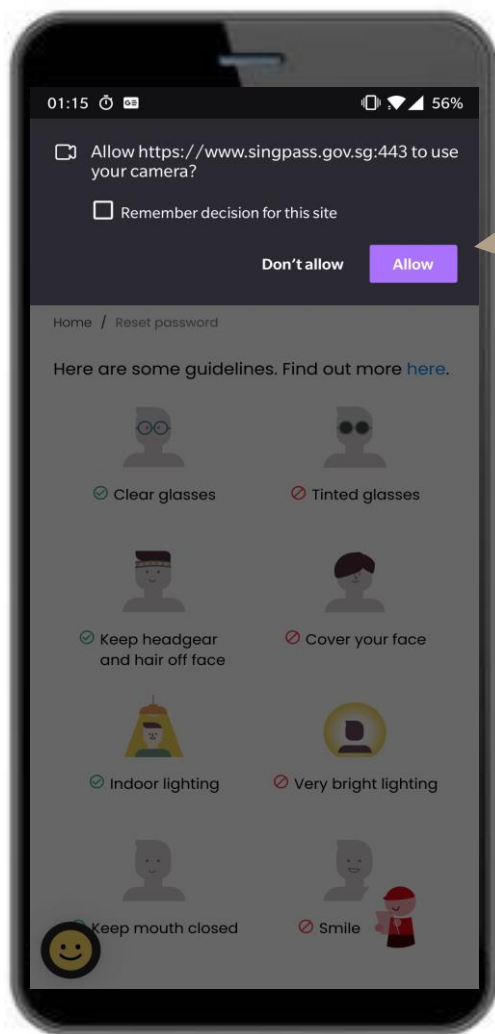

身份验证

10 将脸部置于椭圆形内并保持不动，直至扫描完成。

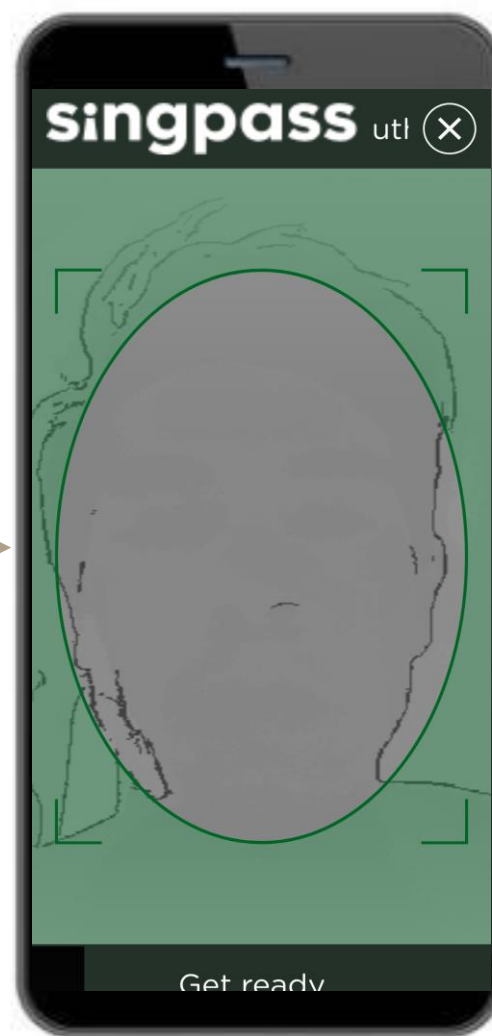
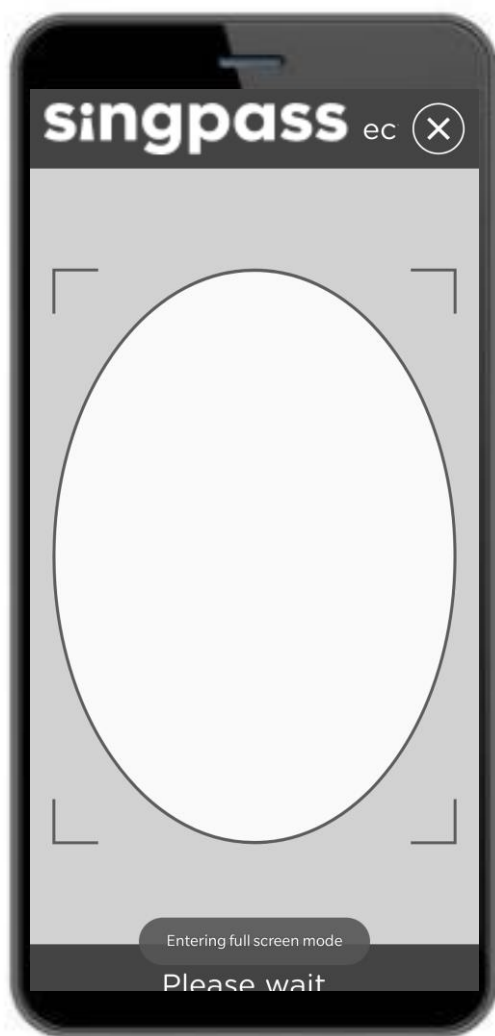

认证证书

11 检查您的详细信息并点击声明框。

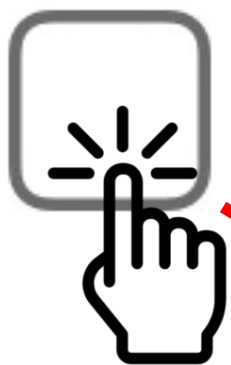
A smartphone screen displaying a form titled "Check your certificates' details". The form contains the following text: "Your authentication and signing certificates will be issued together." Below this, there are two sections: "Name" with "Your name", "NRIC/FIN (For Authentication Certificate)" with "G1234567A", and "Masked NRIC/FIN (For Signing Certificate)" with "G****567A". At the bottom of this section, it says "Certificate issued by Assurity Trusted Solutions Pte. Ltd.". Below the form, there are three checkboxes, each with a red box around it: "My identity details are correct", "I am applying on my own behalf", and "I agree to the terms in the Subscriber Agreement with Assurity Trusted Solutions Pte. Ltd.". Below the checkboxes, it says "What's the Subscriber Agreement?" and "Read more here". At the bottom of the screen, there are two buttons: "Cancel" and "Continue".

12 点击“继续”。

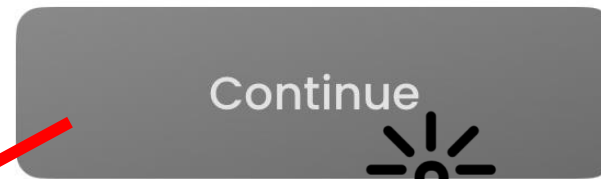

认证证书

13 您的详细身份信息已获确认。点击“继续”。

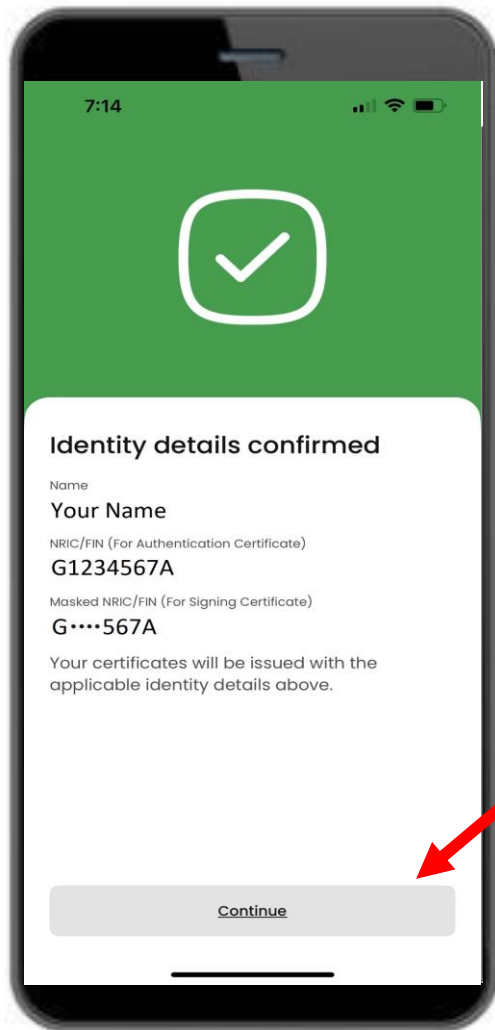

设置应用程序密码

14 输入6位数密码。

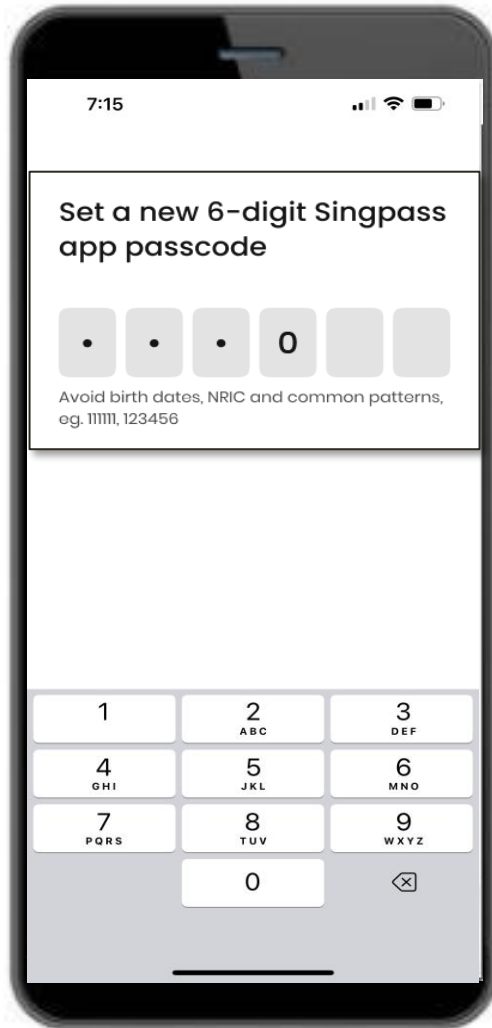

15 重新输入相同的6位数密码。

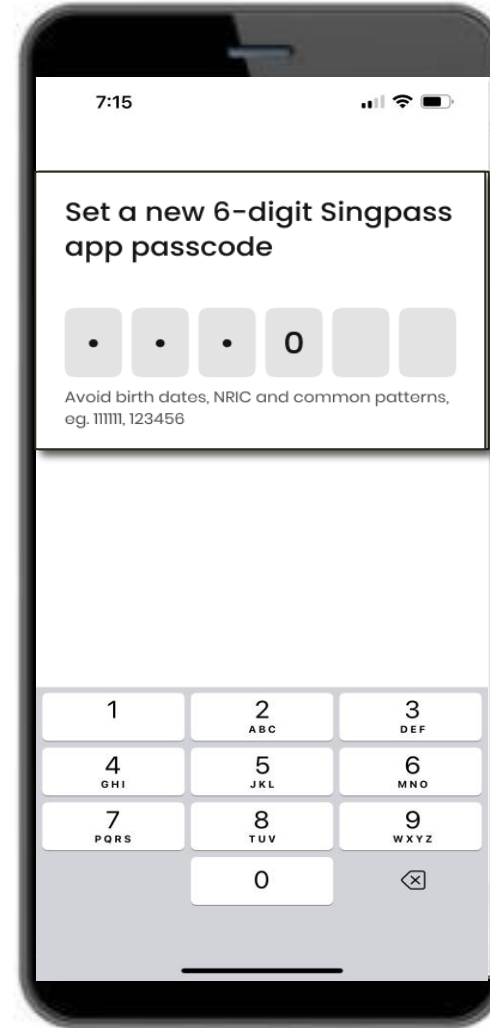

启用生物识别认证

16 您可以选择启用生物识别认证，以使用指纹、人脸等方式登录。

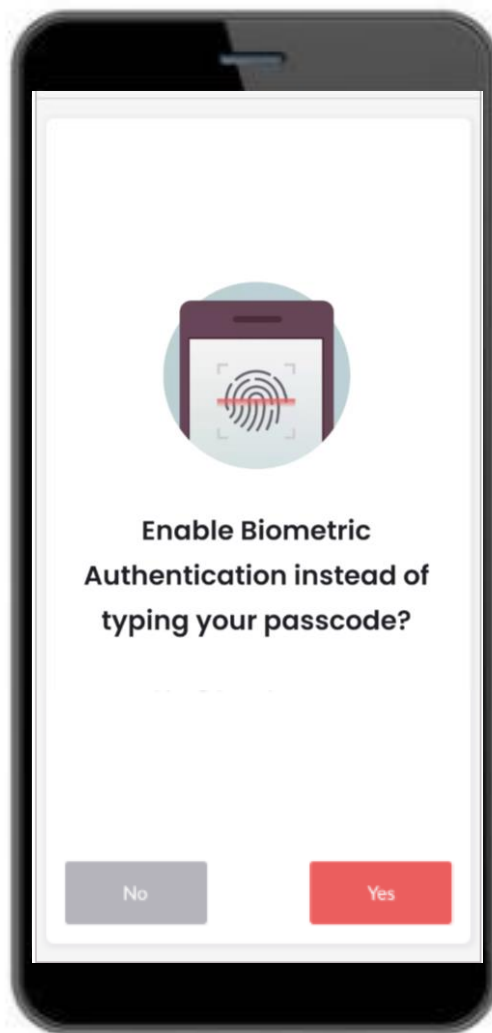

登录服务

17 点击二维码并输入6位数密码

1 点击Singpass登录页面上的二维码

2 在授权页面上，检查网络域名和要登录的数码服务是否正确

3 使用指纹、人脸或6位数密码验证您的身份，然后您就登录了！

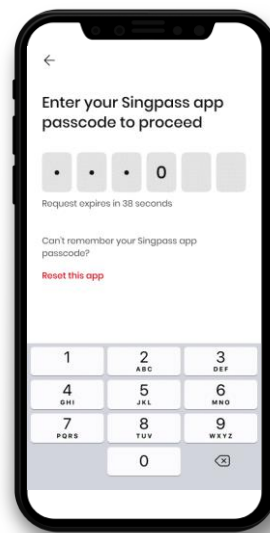
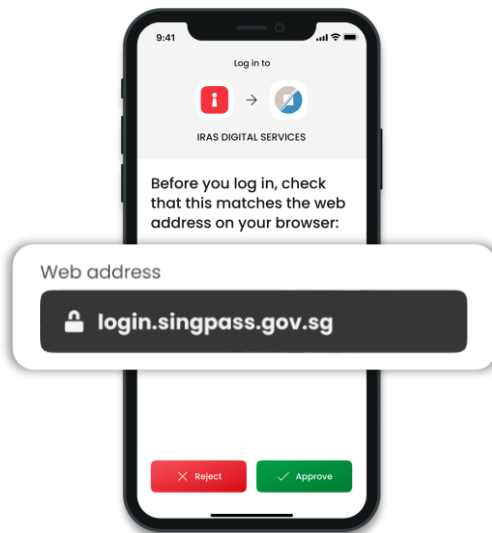

❖ 您已成功设置Singpass应用程序

❖ 按照下一部分的指示安装和设置您的SGWorkPass应用程序



A

添加Singpass应用程序时，请仅从官方应用商店下载。
避免分享您的Singpass ID、密码或双重认证详细信息。

C

检查并确认短信发送者ID为“Singpass”且没有链接或二维码。
检查并确认网络域名为singpass.gov.sg，确认后再输入您的详细信息。

T

如发现不对劲，请告诉Singpass服务台 - 请拨打6335 3533并按“9”。
告诉朋友和家人如何保护他们的Singpass - 访问go.gov.sg/even-safer-singpass



设置 SGWorkPass 应用程序



SGWorkPass-下载



下载SGWORKPASS

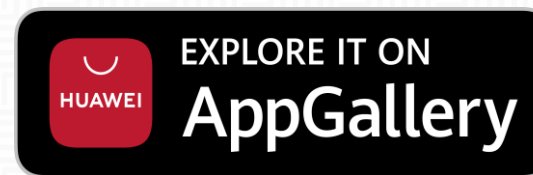
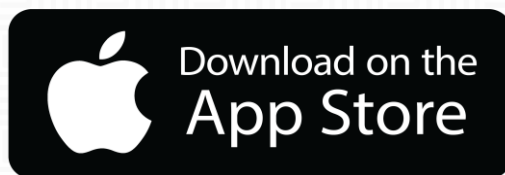



SGWorkPass应用程序-设置

第1步：启动SGWorkPass应用程序，
然后点击“知道了”。

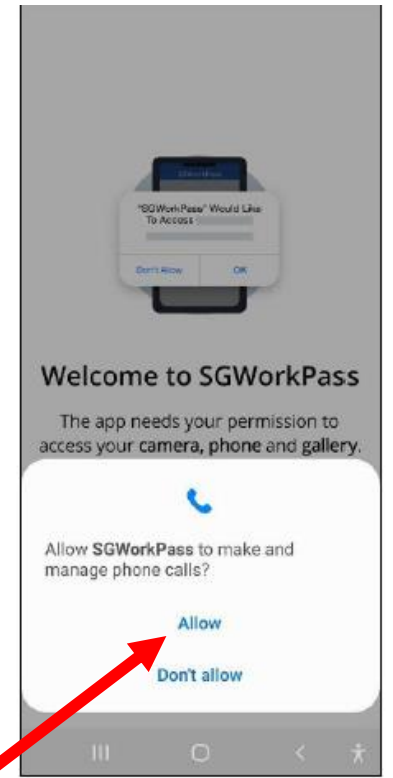
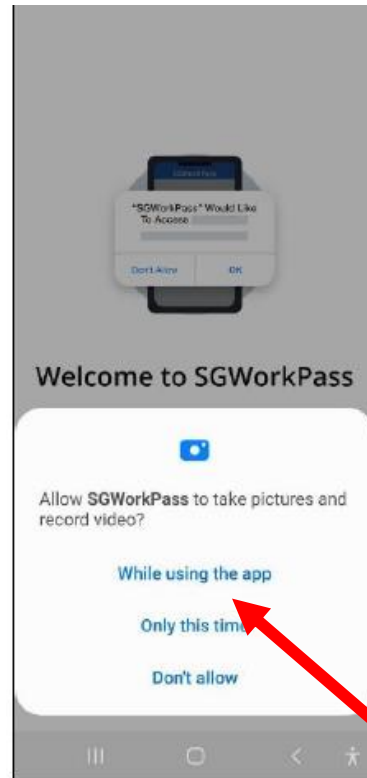
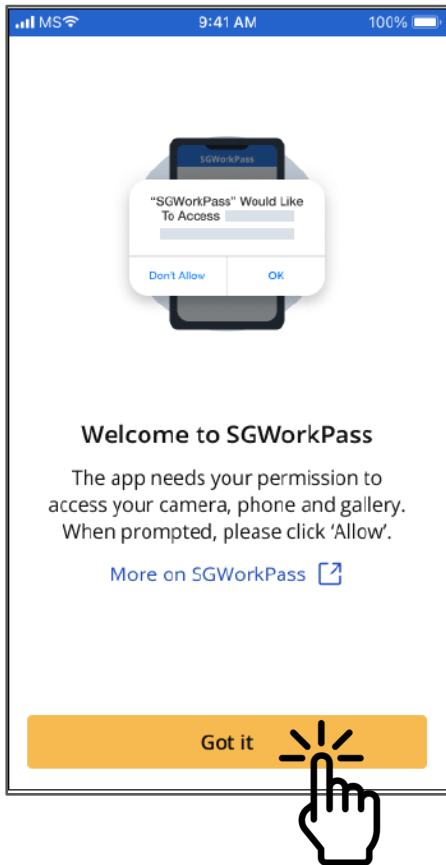

第2步：当页面提示继续设置时，点击“使用应用程序时”和“允许”。



SGWorkPass应用程序-设置

第3步:

选择表明您是人力部颁发的准证持有者的单选按钮。

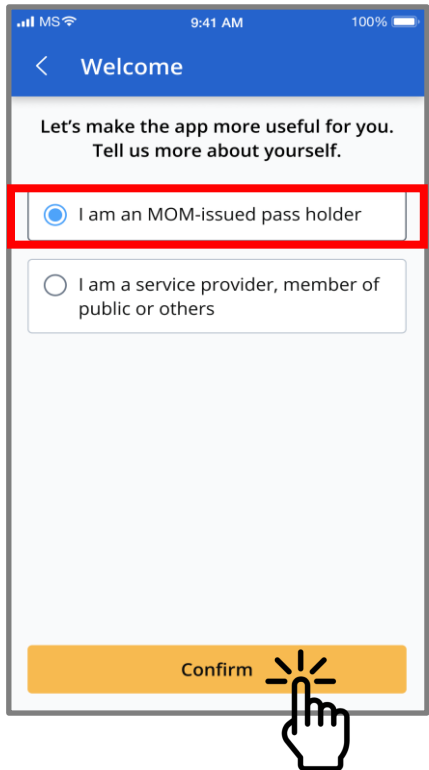

第4步:

点击“使用Singpass登录”。

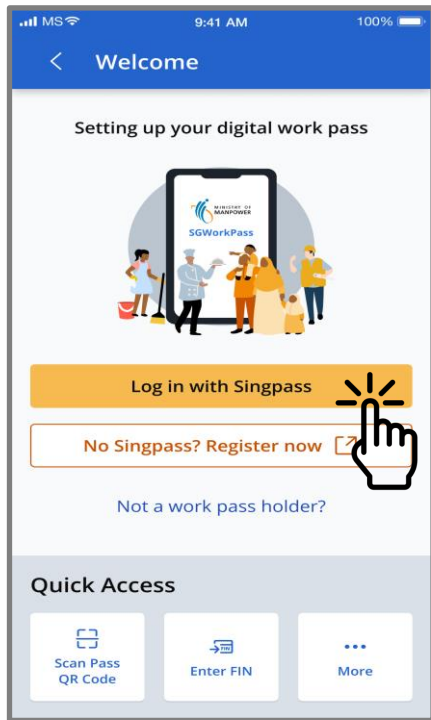

第5步:

点击二维码以登录服务。

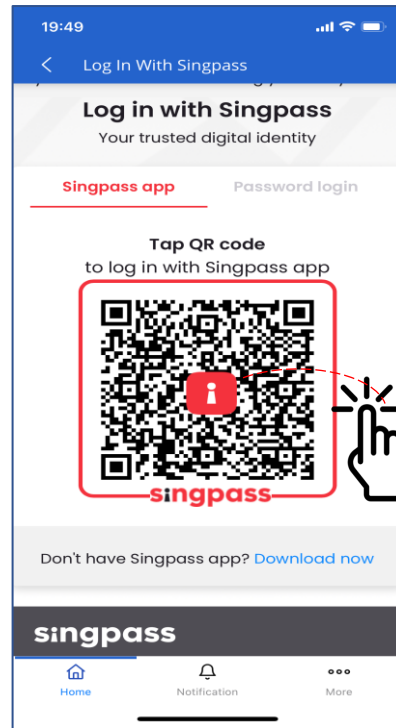

❖ 一旦成功登录应用程序，您的工作准证信息将被显示。

